



HILLMONT

R E S I D E N C E S

FLOOR PLAN

HILLMONT

RESIDENCES

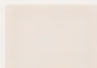
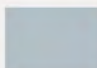
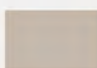

1st FLOOR PLAN

-  STUDIO
-  1 BEDROOM
-  2 BEDROOM
-  3 BEDROOM



HILLMONT

RESIDENCES



2nd - 3rd FLOOR TYPICAL PLAN

- STUDIO
- 1 BEDROOM
- 2 BEDROOM
- 3 BEDROOM



2nd - 3rd FLOOR

KAHRABA NORTH WEST ROAD

HILLMONT

RESIDENCES

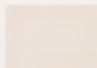
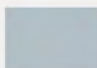
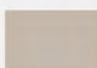

4th - 5th FLOOR TYPICAL PLAN

-  STUDIO
-  1 BEDROOM
-  2 BEDROOM
-  3 BEDROOM



HILLMONT

RESIDENCES

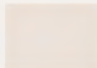
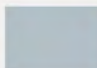
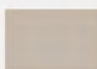

6th - 8th FLOOR TYPICAL PLAN

-  STUDIO
-  1 BEDROOM
-  2 BEDROOM
-  3 BEDROOM



HILLMONT

RESIDENCES

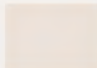
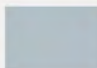
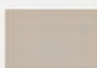

9th - 10th FLOOR TYPICAL PLAN

-  STUDIO
-  1 BEDROOM
-  2 BEDROOM
-  3 BEDROOM



HILLMONT

RESIDENCES



11th FLOOR PLAN

- STUDIO
- 1 BEDROOM
- 2 BEDROOM
- 3 BEDROOM



HILLMONT

RESIDENCES

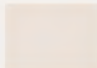
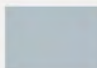
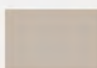

12th FLOOR PLAN

-  STUDIO
-  1 BEDROOM
-  2 BEDROOM
-  3 BEDROOM



STUDIO

TYPE A

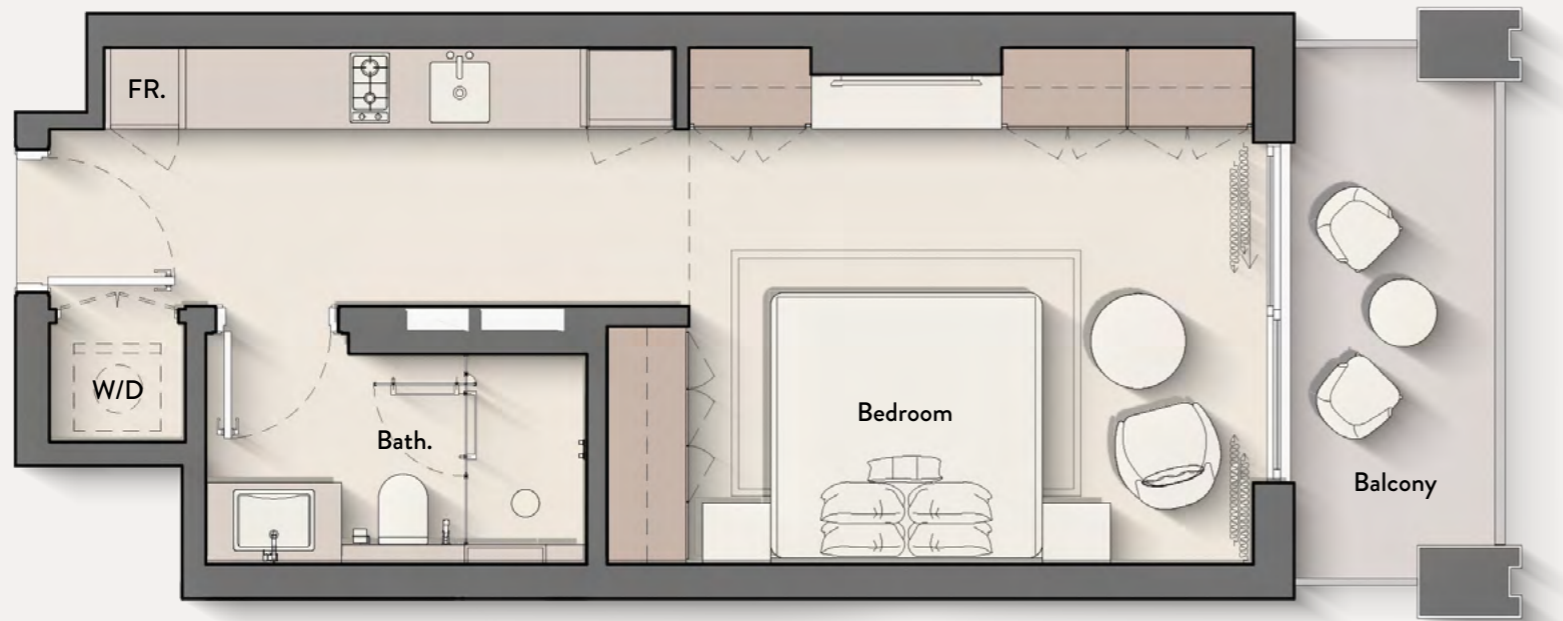

2ND - 3RD FLOOR

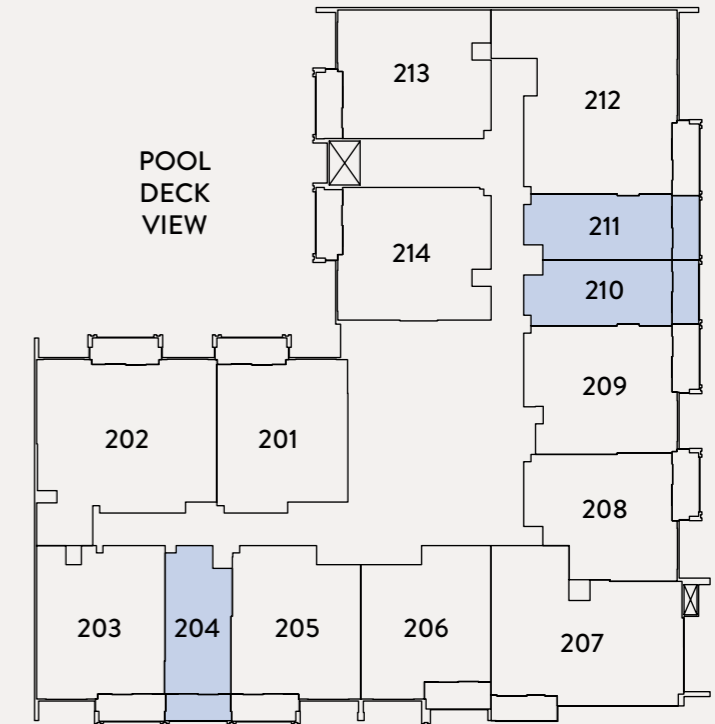

1ST FLOOR

02 09
08

2ND - 3RD FLOOR

04 11
10

4TH - 5TH FLOOR

09
10

INTERNAL LIVING AREA - 381.47 SQ. FT

OUTDOOR LIVING AREA - 70.83 SQ. FT

TOTAL LIVING AREA - 452.30 SQ. FT

1 BEDROOM

TYPE A



2ND - 3RD FLOOR

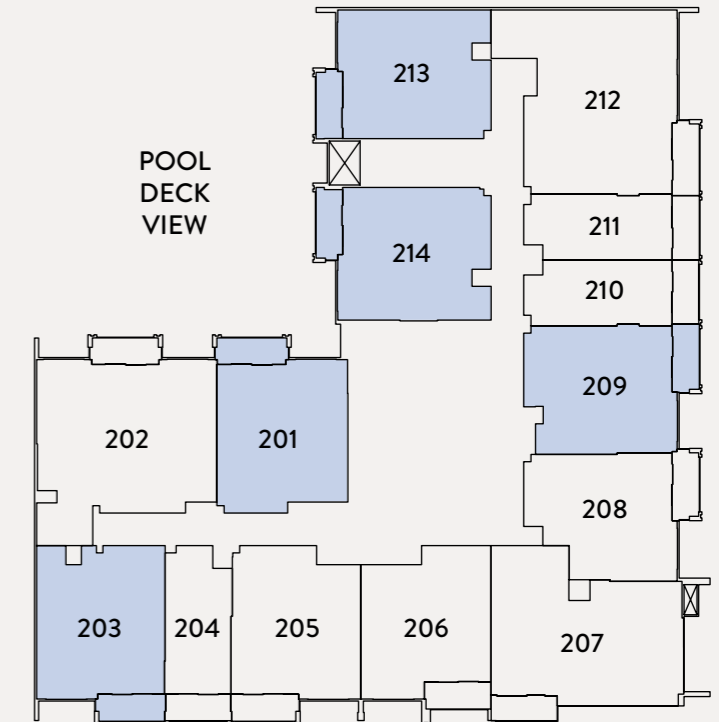

1ST FLOOR

01
07

2ND - 3RD FLOOR

01 09 14
03 13

4TH - 5TH FLOOR

01 12
08 13

6TH - 8TH FLOOR

01 11
08 12

9TH - 10TH FLOOR

01 10
07 11

11TH FLOOR

01 10
07 11

12TH FLOOR

01 10
07 11

INTERNAL LIVING AREA - 755.63 SQ. FT

OUTDOOR LIVING AREA - 73.95 SQ. FT

TOTAL LIVING AREA - 829.57 SQ. FT

1 BEDROOM

TYPE B



2ND - 3RD FLOOR

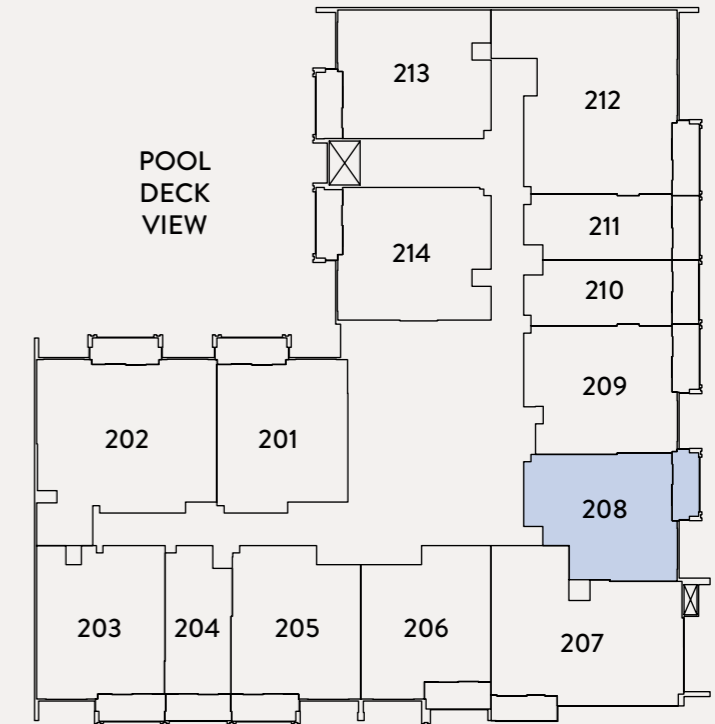

1ST FLOOR

06

2ND - 3RD FLOOR

08

4TH - 5TH FLOOR

07

6TH - 8TH FLOOR

07

INTERNAL LIVING AREA - 696.32 SQ. FT

OUTDOOR LIVING AREA - 74.38 SQ. FT

TOTAL LIVING AREA - 770.70 SQ. FT

1 BEDROOM

TYPE C



2ND - 3RD FLOOR

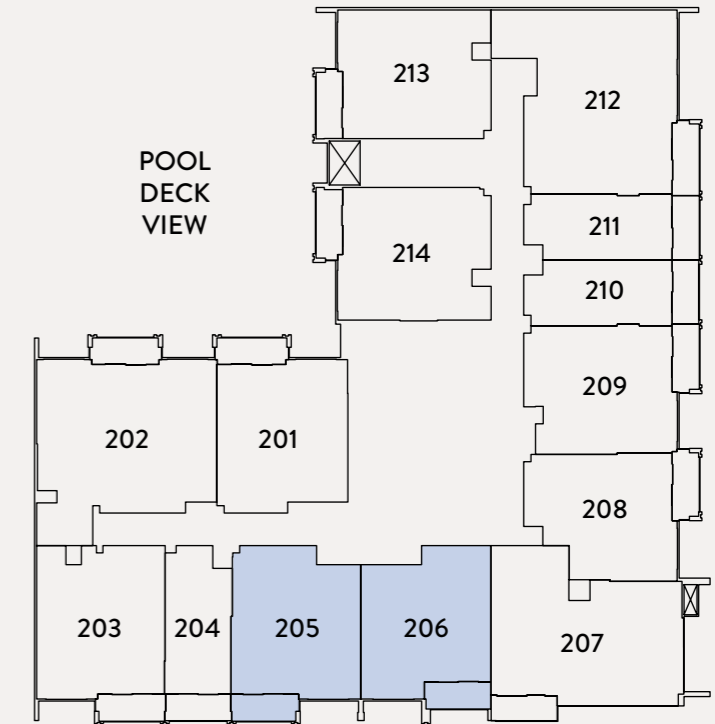

1ST FLOOR

03
04

2ND - 3RD FLOOR

05
06

4TH - 5TH FLOOR

04
05

6TH - 8TH FLOOR

04
05

9TH - 10TH FLOOR

04
05

11TH FLOOR

04
05

12TH FLOOR

04
05

INTERNAL LIVING AREA - 756.06 SQ. FT

OUTDOOR LIVING AREA - 73.63 SQ. FT

TOTAL LIVING AREA - 829.68 SQ. FT

1 BEDROOM

TYPE D



6TH - 8TH FLOOR

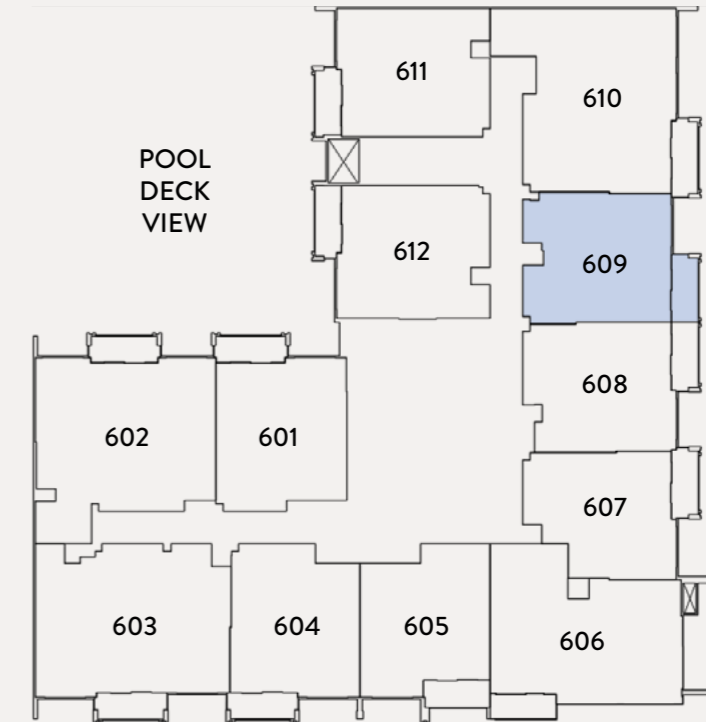

6TH - 8TH FLOOR
09

9TH - 10TH FLOOR
08

11TH FLOOR
08

12TH FLOOR
08

INTERNAL LIVING AREA - 760.47 SQ. FT

OUTDOOR LIVING AREA - 73.19 SQ. FT

TOTAL LIVING AREA - 833.66 SQ. FT

2 BEDROOM

TYPE A



1ST FLOOR

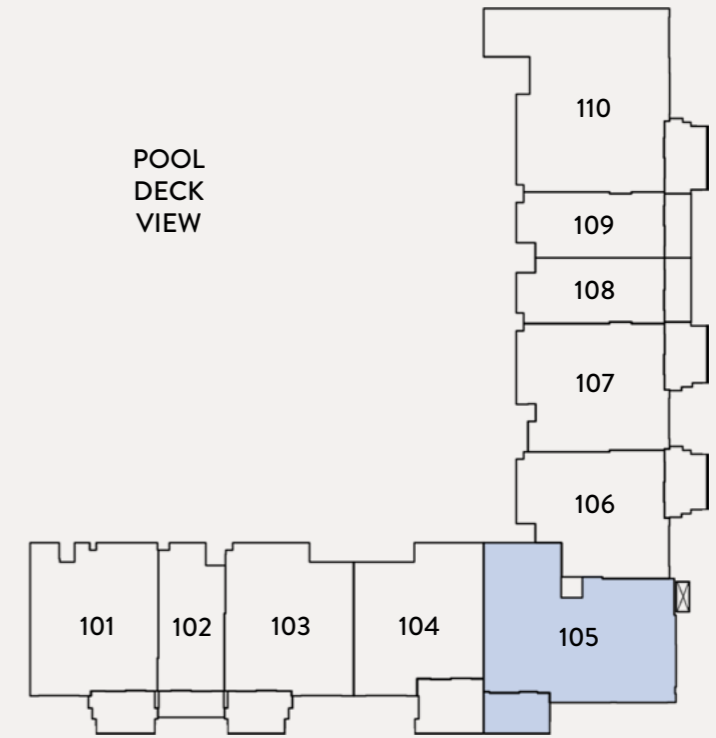

1ST FLOOR

05

2ND - 3RD FLOOR

07

4TH - 5TH FLOOR

06

6TH - 8TH FLOOR

06

INTERNAL LIVING AREA - 1040.98 SQ. FT

OUTDOOR LIVING AREA - 110.22 SQ. FT

TOTAL LIVING AREA - 1151.20 SQ. FT

2 BEDROOM

TYPE B



2ND - 3RD FLOOR

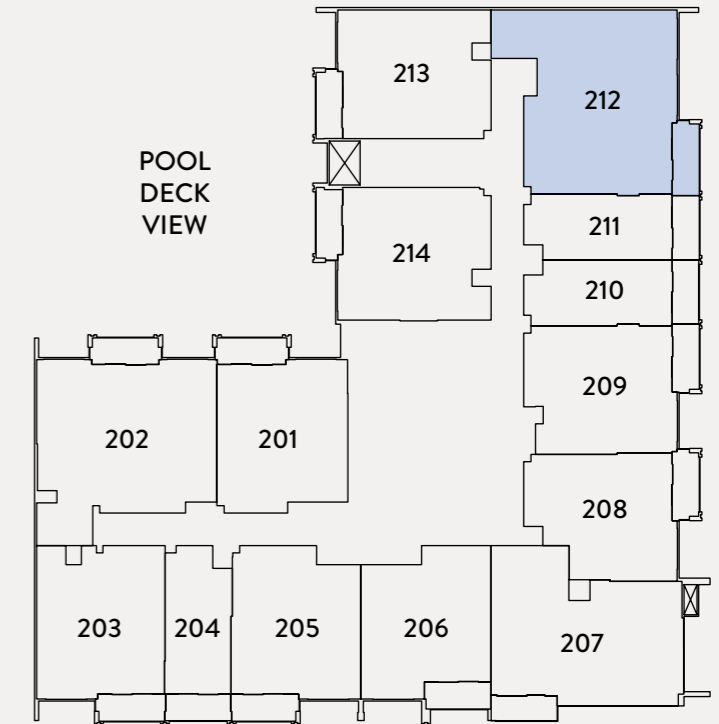

1ST FLOOR
10

2ND - 3RD FLOOR
12

4TH - 5TH FLOOR
11

6TH - 8TH FLOOR
10

9TH - 10TH FLOOR
09

11TH FLOOR
09

12TH FLOOR
09

INTERNAL LIVING AREA - 1176.28 SQ. FT

OUTDOOR LIVING AREA - 80.84 SQ. FT

TOTAL LIVING AREA - 1257.12 SQ. FT

2 BEDROOM

TYPE C



4TH - 5TH FLOOR

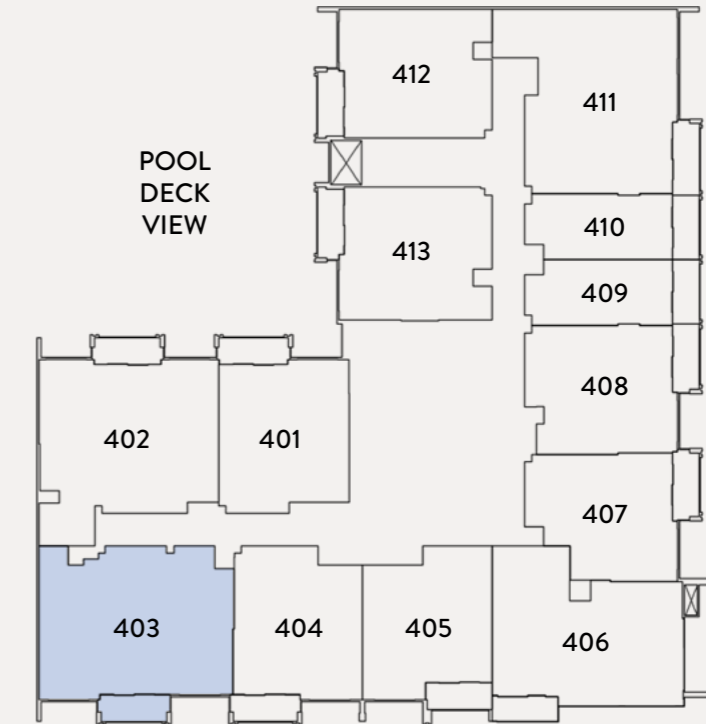

4TH - 5TH FLOOR
03

6TH - 8TH FLOOR
03

9TH - 10TH FLOOR
03

11TH FLOOR
03

12TH FLOOR
03

INTERNAL LIVING AREA - 1148.83 SQ. FT

OUTDOOR LIVING AREA - 76.85 SQ. FT

TOTAL LIVING AREA - 1225.69 SQ. FT

2 BEDROOM + S

TYPE A



2ND - 3RD FLOOR

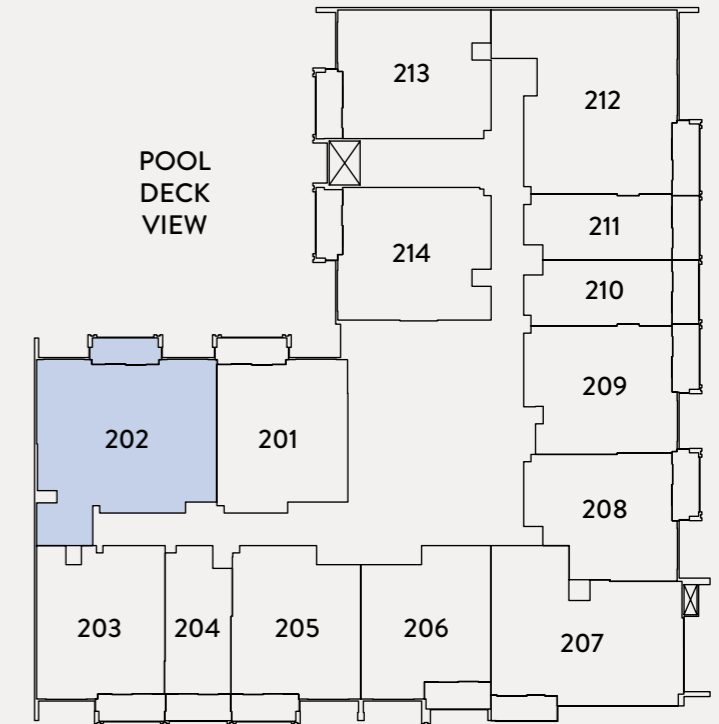

2ND - 3RD FLOOR
02

4TH - 5TH FLOOR
02

6TH - 8TH FLOOR
02

9TH - 10TH FLOOR
02

11TH FLOOR
02

12TH FLOOR
02

INTERNAL LIVING AREA - 1158.09 SQ. FT

OUTDOOR LIVING AREA - 74.38 SQ. FT

TOTAL LIVING AREA - 1232.47 SQ. FT

3 BEDROOM

TYPE A



9TH - 10TH FLOOR

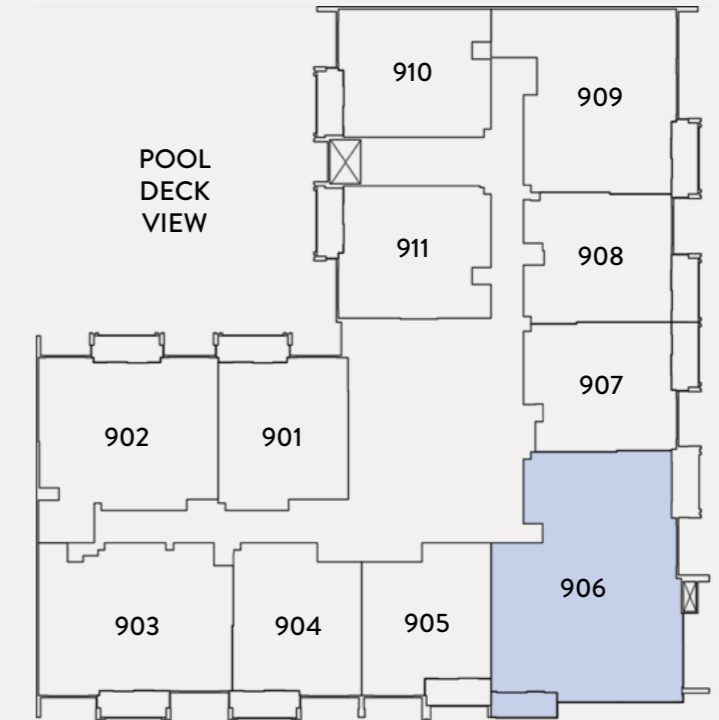

9TH - 10TH FLOOR

06

INTERNAL LIVING AREA - 1737.94 SQ. FT

OUTDOOR LIVING AREA - 67.38 SQ. FT

TOTAL LIVING AREA - 1805.32 SQ. FT

3 BEDROOM

TYPE B



11TH FLOOR

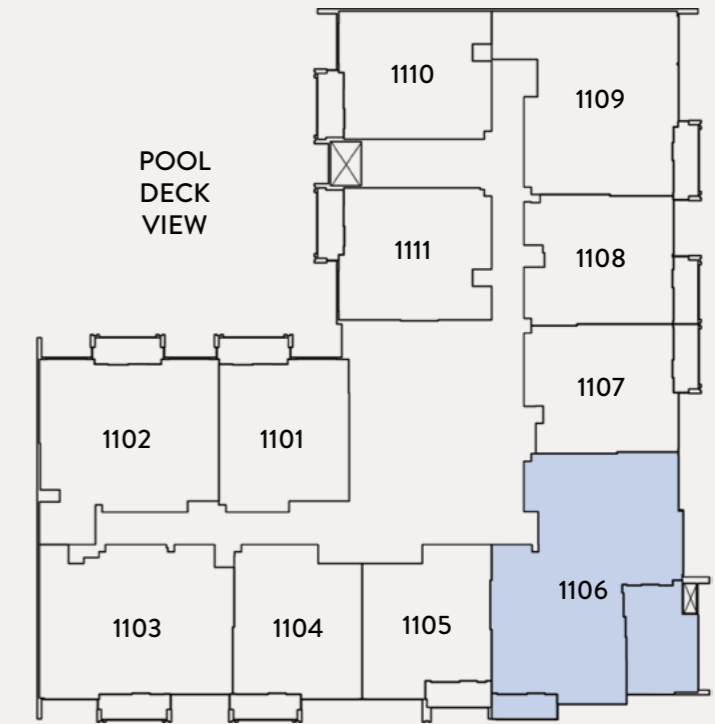

11TH FLOOR
06

12TH FLOOR
06

INTERNAL LIVING AREA - 1489.40 SQ. FT

OUTDOOR LIVING AREA - 375.12 SQ. FT

TOTAL LIVING AREA - 1864.52 SQ. FT



800 8288
info@ellingtongroup.com

ELLINGTONPROPERTIES.AE

The renderings and visualizations contained in this brochure are provided for illustrative and marketing purposes. While the information provided is believed to be accurate and reliable at the time of printing, only the information contained in the final Sales and Purchase Agreement will have any legal effect.